

The image is a full-page background photograph. It depicts a modern architectural interior, likely a staircase or a narrow hallway. The lighting is dramatic, with strong shadows and highlights. On the left, a dark metal railing is visible. The floor is made of large, dark rectangular tiles. The walls are covered in large, light-colored rectangular panels. A series of small, rectangular, glowing lights are embedded in the wall on the right side, creating a rhythmic pattern of light and shadow. The overall mood is sophisticated and contemporary.

# Anti-flooding valves and basement drains

*Protection and drainage  
of basement areas*

**DALLMER**

Anti-flooding valves and basement drains

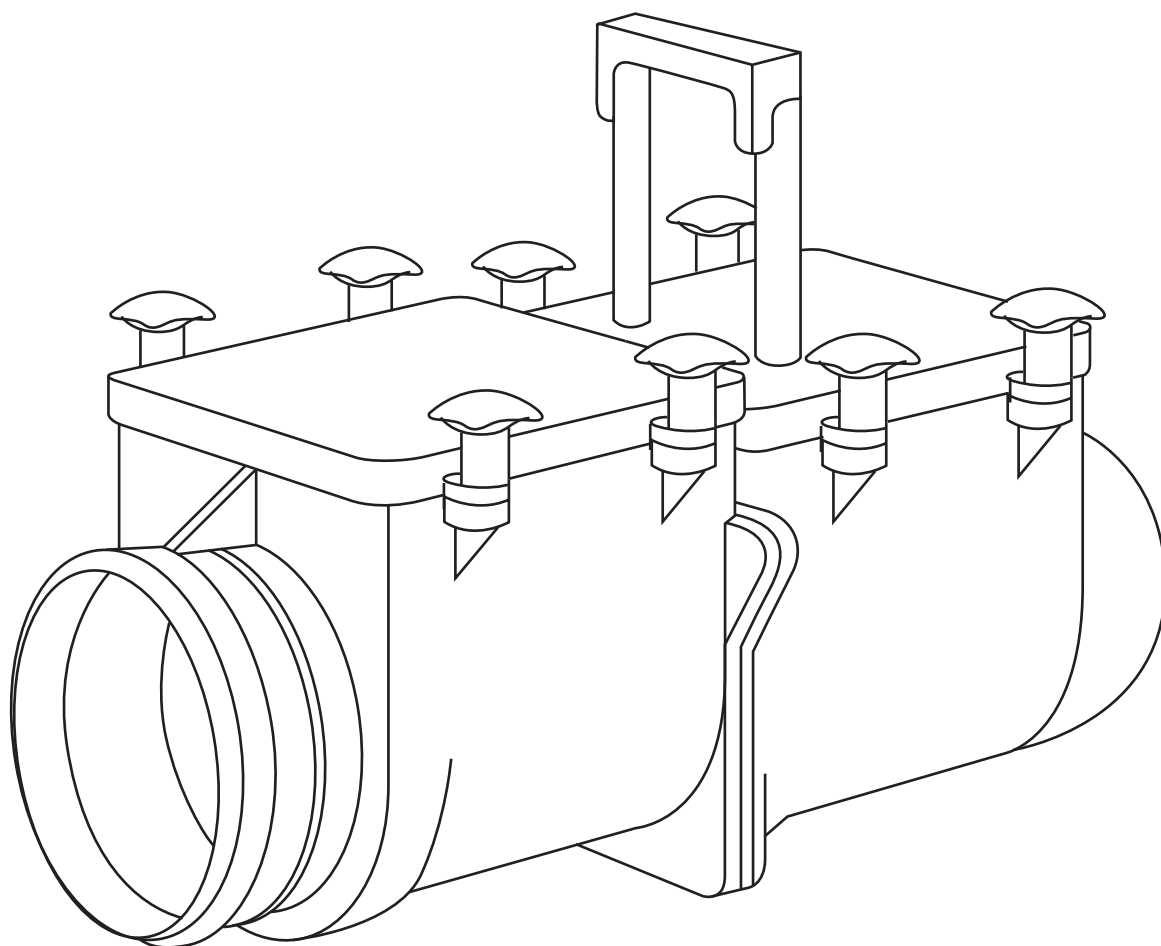

Anti-flooding valves 6

Anti-flooding basement drains 17

Utility drains without anti-flooding device 21



# Anti-flooding valves

---

## Stausafe RS

Type 2 according to EN 13564 – 1:2002 (DN 100 – DN 150),  
Application according to DIN 1986 – 100:2002 – 03:  
suitable for waste water

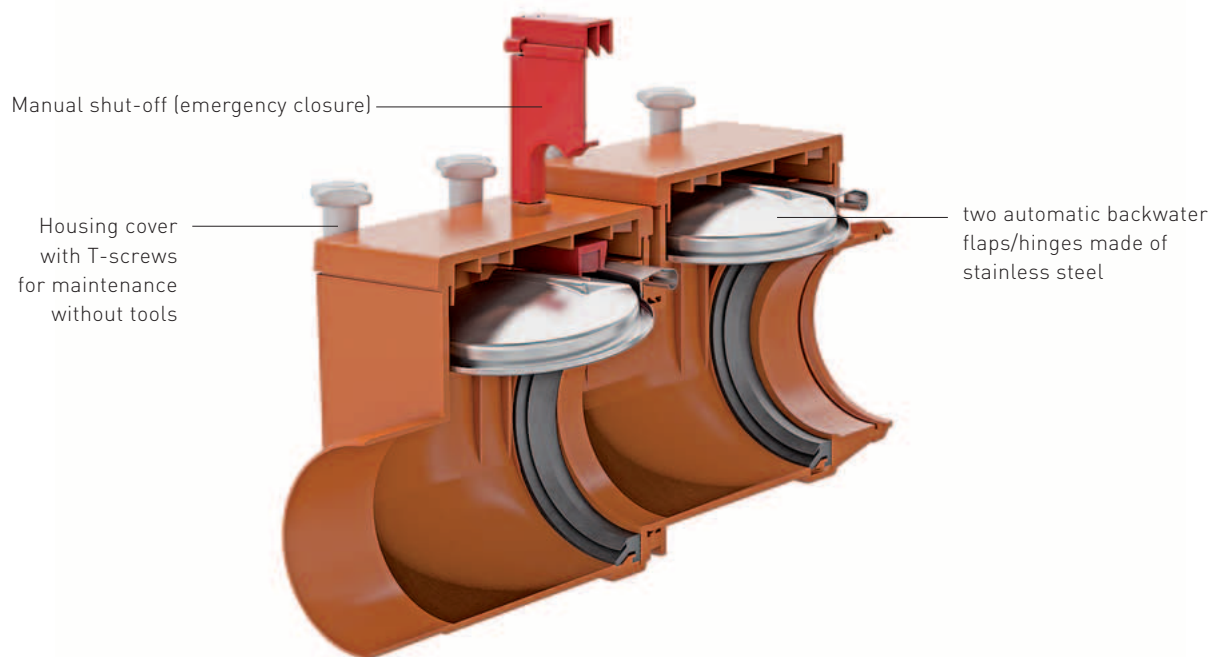



# Anti-flooding valves

## Applications and products

Ever since sewer systems have existed, there has been a problem or knowledge of backflow from sewers. When drainage items and surfaces that are located below the flood level are connected without safety devices, damage from backflow is inevitable. This can be a distressing event, even if covered by insurance. The integration of flood protection using anti-flooding valves is simple.

Note:  
Document H of the UK Building Regulations permits Stausafe RS in black water drainage.

Application	Types of anti-flooding valves according to DIN EN 13564 or DIN 1986-100 approved for application	DALLMER Anti-flooding valves
Waste water free of faecal matter, storm water	Types 2, 3 and 5	Stausafe RS; Stausafe F; Ballstau
Waste water with faecal matter	Type 3 marked "F"	Stausafe F
Rain water systems	Types 0, 1 and 2	Stausafe RS

### Anti-flooding valves can be used when ...

- there is a sufficient slope to the sewer.
- the rooms have a secondary use, which means no significant material values or health and welfare of the residents are impacted in the event of flooding.
- the user number is small and a lavatory is available above the backwater level.

### Overview table for products and explanations

Dallmer product	Explanation
Stausafe RS (Type 2)	Anti-flooding valves for the use of horizontal lines with two self-acting flaps and an emergency closure, whereby this emergency closure may be combined with one of the two self-acting flaps.
Stausafe F (Type 3)	Anti-flooding valves for the use with horizontal lines with a self-acting closure that is operated with external energy (electrical, pneumatic or others) and an emergency closure that is separate from the self-acting closure.
Ballstau (Type 5)	Anti-flooding valves that is integrated in drain fixtures or floor drains with two self-acting flaps and an emergency closure, whereby this emergency closure may be combined with one of the two self-acting flaps.
Pipe flap	For underground storm water tank overflow only

# Anti-flooding valves

## Anti-flooding valves dimensions

### Stausafe F

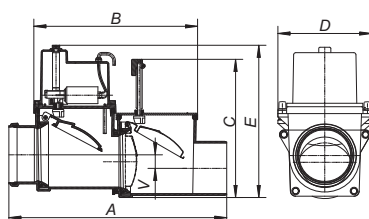

REFERENCE WIDTH	A (mm)	B (mm)	C (mm)	D (mm)	E (mm)	V (mm)
DN 70	490	378	220 – 320	217	352	31
DN 100	503	378	220 – 320	217	352	31
DN 125	590	425	261 – 349	253	371	23

### Stausafe E / H



Stausafe E



Stausafe H

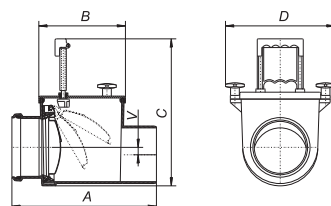

REFERENCE WIDTH	A (mm)	B (mm)	C (mm)	D (mm)	V (mm)
DN 100	302	185	220 – 320	240	14.5
DN 125	315	185	220 – 320	240	16.5
DN 150	376	212	261 – 349	274	11.5
DN 200	445	165	248 – 348	258	20.0

### Stausafe RS

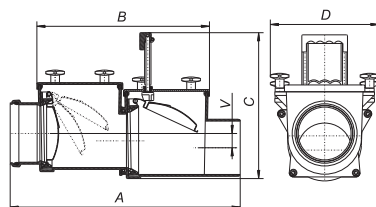

REFERENCE WIDTH	A (mm)	B (mm)	C (mm)	D (mm)	V (mm)
DN 100	490	378	220 – 320	240	31
DN 125	503	378	220 – 320	240	31
DN 150	590	425	261 – 349	274	23
DN 200	615	335	248 – 348	258	40

# Anti-flooding valves

## Stausafe F

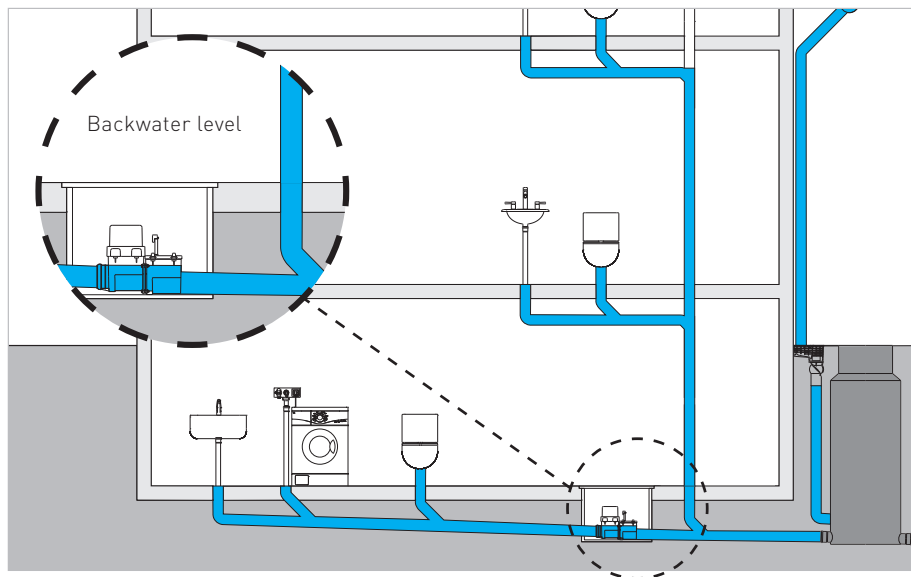

Correct!

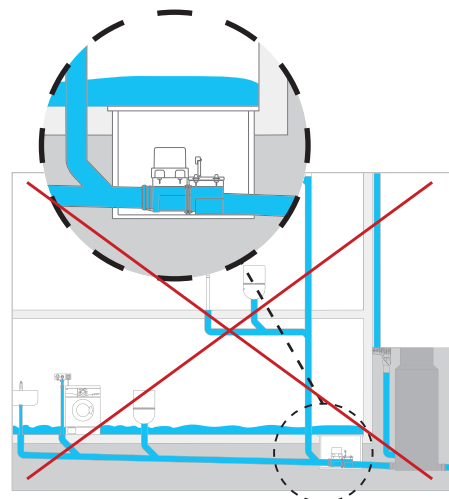

Incorrect!

### Planning and installation

The installation location for the Stausafe F must be selected so that all drain points at risk of flooding are protected. Layout must prevent downpipes from higher floors are located above the backwater level are

routed through the Stausafe. The functional parts that are integrated in the backwater closure for service work must be accessible and it must be possible to run a functional check (according to DIN 1986-33).

### Note

Observe a rest period of at least 1 m before and after the anti-flooding valves.

The Stausafe has a factory height variance of 31 mm between the inlet and outlet lines. A minimum slope of 1% must be used.

The anti-flooding valve must be fitted horizontally in the pipe run.

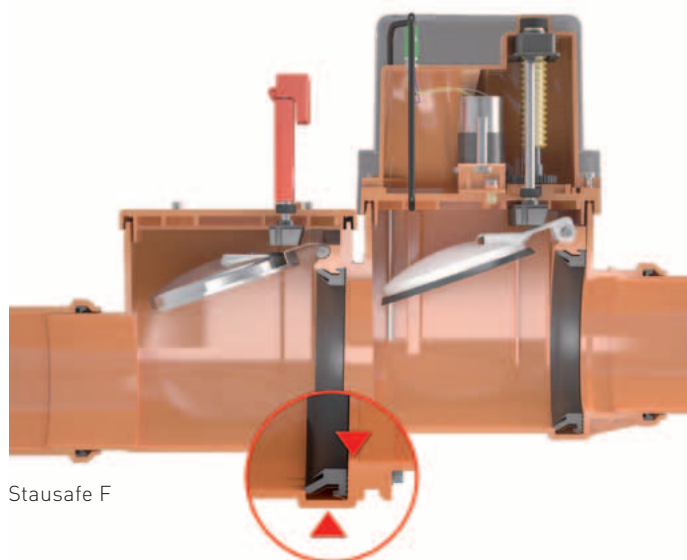

Stausafe F



# Anti-flooding valves

## Stausafe F

### Mode of operation

A sensor integrated in the anti-flooding valves detects water and closes flap using a shaft operated by an electric motor. Even in the event of a complete power failure, all safety functions are maintained by integrated emergency power supply (conventional 8 x AA Alkali-Manganese 1.5 V batteries) for a maximum of 4 days. If water recedes, the flap re-opens.

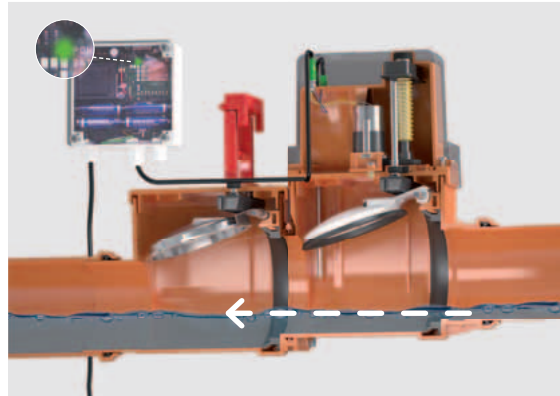

Standard operation

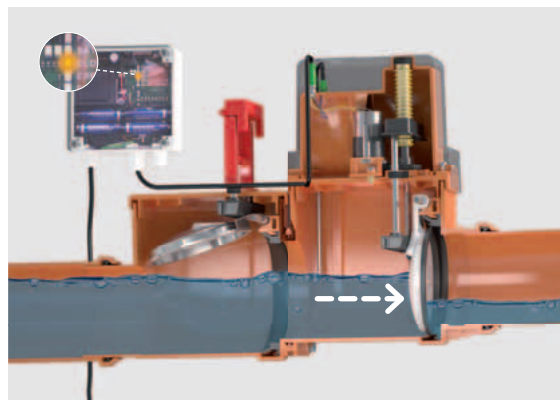

Function in the event of backwater

### Electronic connection

The switch housing is protected according to DN VDE 0470 (IP 65). The connecting line between the Stausafe and switch housing is 6 m long.

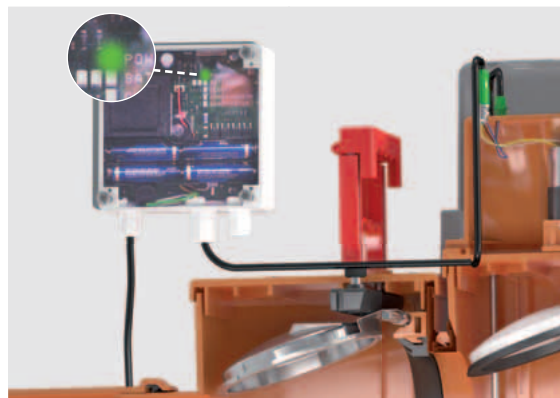

Switching device

# Anti-flooding valves

## DALLMER anti-flooding valve Stausafe E

for use with rain water systems

### SPECIFICATION

- self-closing stainless steel flap
- stainless steel pivots
- easy to maintain ABS housing
- inspection cover with wingnuts can be opened for maintenance without tools

ITEM	DN	PART NO.
anti-flooding valve Stausafe E	DN 100	661067
anti-flooding valve Stausafe E	DN 125	661081
anti-flooding valve Stausafe E	DN 150	661098
anti-flooding valve Stausafe E	DN 200	660008



anti-flooding valve Stausafe E

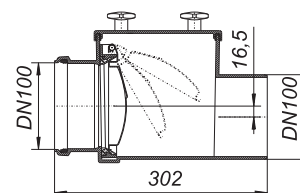

## DALLMER anti-flooding valve Stausafe H

for use with rain water systems

### SPECIFICATION

- self-closing stainless steel flap
- manually operated lock
- stainless steel pivots
- easy to maintain ABS housing
- inspection cover with wingnuts can be opened for maintenance without tools

ITEM	DN	PART NO.
anti-flooding valve Stausafe H	DN 100	661166
anti-flooding valve Stausafe H	DN 125	661180
anti-flooding valve Stausafe H	DN 150	661197
anti-flooding valve Stausafe H	DN 200	660107



anti-flooding valve Stausafe H

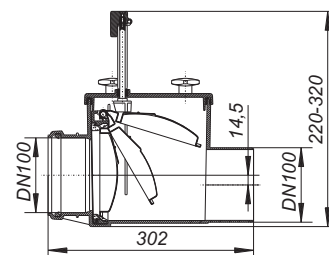

## DALLMER anti-flooding valve Stausafe RS

for EN 13564-1:2002 (DN 100-DN 150), type 2  
operation conforms to DIN 1986-100:2002-03

### SPECIFICATION

- twin self-closing stainless steel flaps
- manually operated lock
- stainless steel pivots
- test-port
- easy to maintain ABS housing
- inspection cover with wingnuts can be opened for maintenance without tools

ITEM	DN	PART NO.
anti-flooding valve Stausafe RS	DN 100	661265
anti-flooding valve Stausafe RS	DN 125	661289
anti-flooding valve Stausafe RS	DN 150	661296
anti-flooding valve Stausafe RS	DN 200	660206



anti-flooding valve Stausafe RS

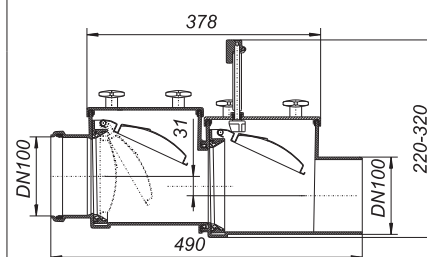

**Note:** Local regulations outside Germany may allow use on sewage lines.  
eg. Document H of the UK Building Regulations.

Dimensions of Dallmer anti-flooding valves on page 7.

# Anti-flooding valves

## DALLMER anti-flooding conversion kit Stausafe RS in F

complete kit incl. electronic controls and cables to convert an anti-flooding valve type Stausafe RS to type Stausafe F for use with faecal waste water

ITEM	DN	PART NO.
anti-flooding conversion kit Stausafe RS in F	DN 100/DN 125	664402
anti-flooding conversion kit Stausafe RS in F	DN 150	664426



anti-flooding conversion kit

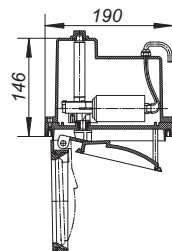

## DALLMER anti-flooding valve Stausafe F

according to EN 13564 type 3 (F)  
operation conforms to DIN 1986-100:2002-03 for use with faecal waste water

### SPECIFICATION

- electronic flood sensor
- flap with electrically operated lock
- secondary stainless steel flap with manual lock
- stainless steel pivots
- sealed compartment for motor
- emergency power by batteries
- test-port
- easy-to-install ABS housing
- inspection cover with wingnuts can be opened for maintenance without tools
- electronic controls in box for on-wall mounting with warning lamp/ buzzer can be used with central building control systems

flaps: 316Ti stainless steel/HDPE  
power supply: 230 V/0,5 A  
connection cable: 6 m, PUR, 5 x 0.75 mm<sup>2</sup>  
motor supply: 12 V low voltage  
emergency power: batteries, max. 6 days  
sensor: coaxial electrode  
sealing force: 500 newtons  
closing time: approx. 9 seconds

ITEM	DN	PART NO.
anti-flooding valve Stausafe F	DN 100	661562
anti-flooding valve Stausafe F	DN 125	661586
anti-flooding valve Stausafe F	DN 150	661593

The motorized flap and its related components can be supplied separately, to convert a type RS valve to type F specification, parts 664402/664426.

Dimensions of Dallmer anti-flooding valves on page 7.

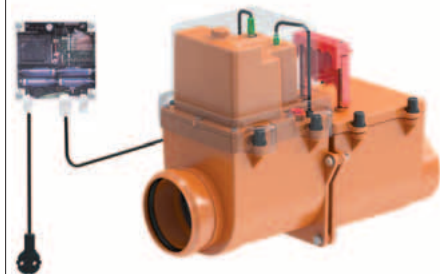

anti-flooding valve Stausafe F

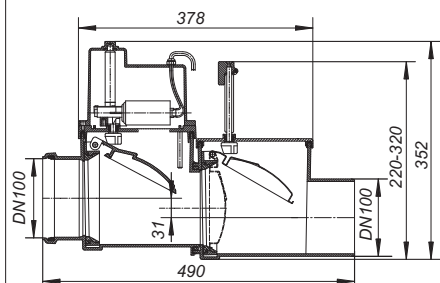

# Anti-flooding valves

## DALLMER flap-valve

### SPECIFICATION

- stainless steel flap
- stainless steel pivots
- ring-seal socket connects to plastic pipework

### MATERIAL

ABS

ITEM	DN	PART NO.
flap-valve	DN 100	660367
flap-valve	DN 125	660381
flap-valve	DN 150	660398
flap-valve	DN 200	660305

Flap-valves allow free drainage, for example to a manhole, whilst preventing ingress of debris or vermin.



flap-valve

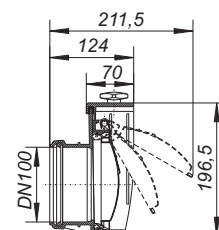

## DALLMER rodding access Stausafe R

for installation in pipework as a rodding point  
or for subsequent conversion to an anti-flooding valve

### SPECIFICATION

- easy to maintain ABS housing
- inspection cover with wingnuts can be opened for maintenance without tools

ITEM	DN	PART NO.
rodding access Stausafe R	DN 100	661661
rodding access Stausafe R	DN 125	661685
rodding access Stausafe R	DN 150	661692



rodding access Stausafe R

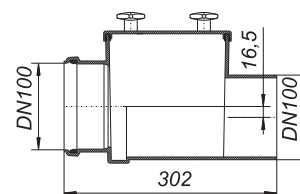

## DALLMER non-return valve RS 4

vertical or horizontal installation,  
with rising ball seal

### MATERIAL

body polypropylene

- ▶ **non-return valve RS 4.5**  
DN 50, with two cleaning eyes
- ▶ **non-return valve RS 4.7**  
DN 70, with one cleaning eye

ITEM	DN	PART NO.
non-return valve RS 4.5	DN 50	840028
non-return valve RS 4.7	DN 70	840042

RS 4 non-return valves give a practical solution to back-flow in "problem" installations. The rising-ball mechanism prevents water flowing back into baths or showers. Type RS 4 non-return valves are used to prevent back-flow in pipework, but should not be regarded as anti-flooding valves conforming to DIN 1997. These non-return valves are not permitted to be installed instead of anti-flooding valves below flood level.



Rückfluss-Sicherung RS 4.5

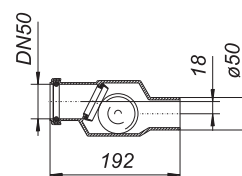

non-return valve RS 4.7

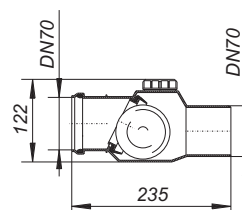

# Anti-flooding valves

## DALLMER testing funnel 1/2"

for checking sealing on Ballstau 110 drain and Stausafe anti-flooding valves

ITEM	DIMENSION	PART NO.
testing funnel	1/2"	724847



testing funnel

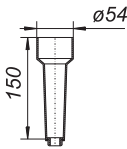

## DALLMER test-port plug 1/2"

spare part for Ballstau 110 drain and Stausafe anti-flooding valves

ITEM	DIMENSION	PART NO.
test-port plug	1/2"	724854



test-port plug

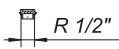







# Anti-flooding basement drains

---

## Anti-flooding basement drain

Type 5 conforming to EN 13564, application according to DN 1986 – DN 100:2002 - 03: suitable for waste water that is free of faecal matter.

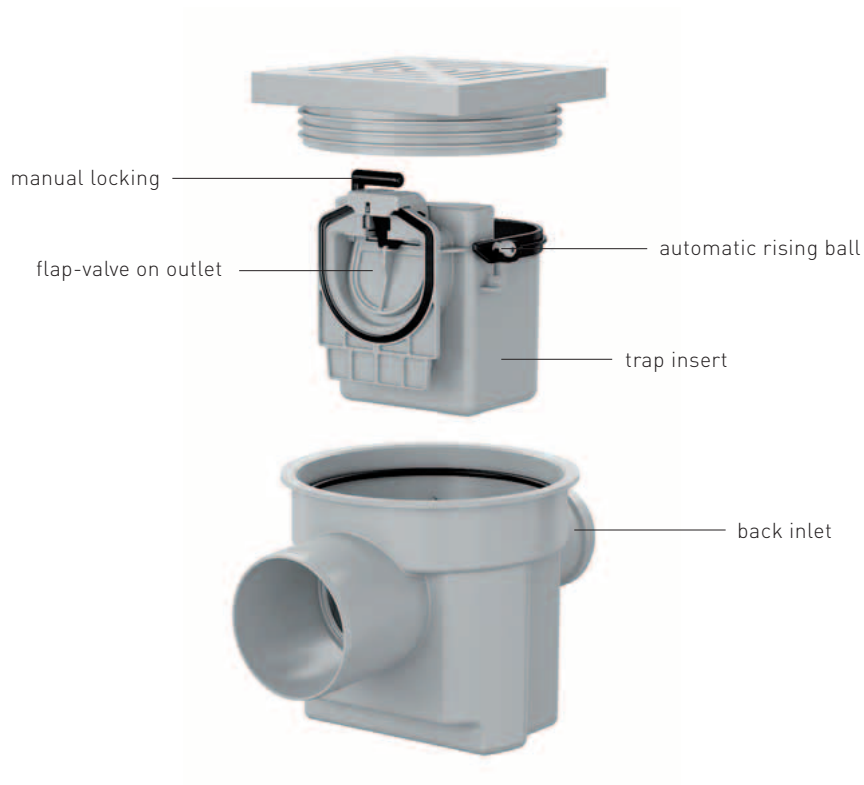

# Anti-flooding basement drains

## DALLMER anti-flooding drain Ballstau 110

for EN 13564 type 5, operation conforms to DIN 1986-100:2002-03  
for use with grey waste water  
outlet DN 100 horizontal (3 degrees fall)

### SPECIFICATION

- automatic rising ball
- flap-valve on outlet
- manual lock
- replaceable rising ball assembly
- test-port

### MATERIAL

body ABS  
grate ABS, 2-piece, load class K 3 (300 kg)

- ▶ anti-flooding drain Ballstau 110/1  
with DN 50 side inlet
- ▶ anti-flooding drain Ballstau 110/3  
with DN 70 side inlet and two DN 70 bosses for alternative side inlet location

### FLOW RATE TESTED TO DIN EN 1253 (with 20 mm water over grate)

	Required	Dallmer
DN 100	1.4 l/s	1.62 l/s

ITEM	DN	PART NO.
anti-flooding drain Ballstau 110	DN 100	720061
anti-flooding drain Ballstau 110/1	DN 100	720160
anti-flooding drain Ballstau 110/3	DN 100	720368



anti-flooding drain Ballstau 110

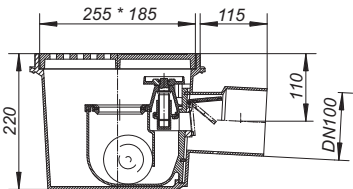

anti-flooding drain Ballstau 110

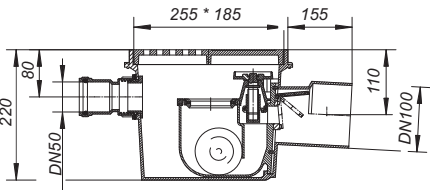

anti-flooding drain Ballstau 110

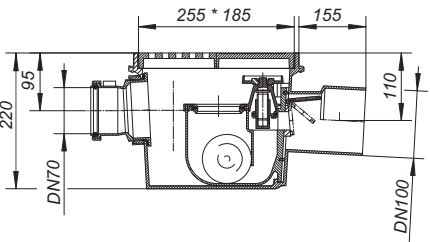

## DALLMER side inlet connectors

used with utility drain types 71/1 or 71/3 and Ballstau 110/1 or 110/3

ITEM	DN	PART NO.
side inlet connectors	DN 50	724724
side inlet connectors	DN 70	724748



connectors

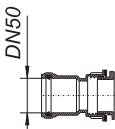

# Anti-flooding basement drains

## DALLMER extension for Ballstau 110

used with type 110 Ballstau drain  
can be cut to correct height on site

### MATERIAL

ABS, grey

ITEM	DIMENSION	PART NO.
extension for Ballstau 110	100 mm	724953



extension for Ballstau 110

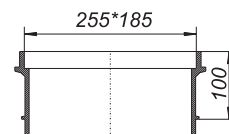

## DALLMER grate for Ballstau 110

used with type 110 Ballstau drain

- ▶ **grate for Ballstau 110, grey**  
two-part, ABS, grey, 250 x 180 mm, load class K 3 (300 kg)
- ▶ **grate for Ballstau 110, white**  
two-part, ABS, white, 250 x 180 mm, load class K 3 (300 kg)
- ▶ **grate for Ballstau 110, stainless steel**  
one-part, stainless steel, 250 x 180 mm, load class K 3 (300 kg)

ITEM	DIMENSION	PART NO.
grate for Ballstau 110, grey	250 x 180 mm	724922
grate for Ballstau 110, white	250 x 180 mm	724939
grate for Ballstau 110, stainless steel	250 x 180 mm	724762



grate for Ballstau 110, grey

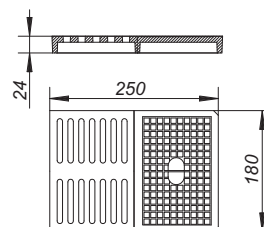

## DALLMER testing funnel 1/2"

for checking sealing on Ballstau 110 drain and Stausafe anti-flooding valves

ITEM	DIMENSION	PART NO.
testing funnel	1/2"	724847



testing funnel

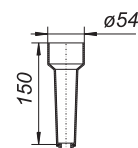

## DALLMER test-port plug 1/2"

spare part for Ballstau 110 drain and Stausafe anti-flooding valves

ITEM	DIMENSION	PART NO.
test-port plug	1/2"	724854



test-port plug





# Utility drains without anti-flooding device

---

## utility drain type 61 AK

- confirming to DIN EN 1253
- DN 100 drain pipe, vertical
- removable bell trap, seal water height 50 mm
- hair sieve
- height-adjustable attachment

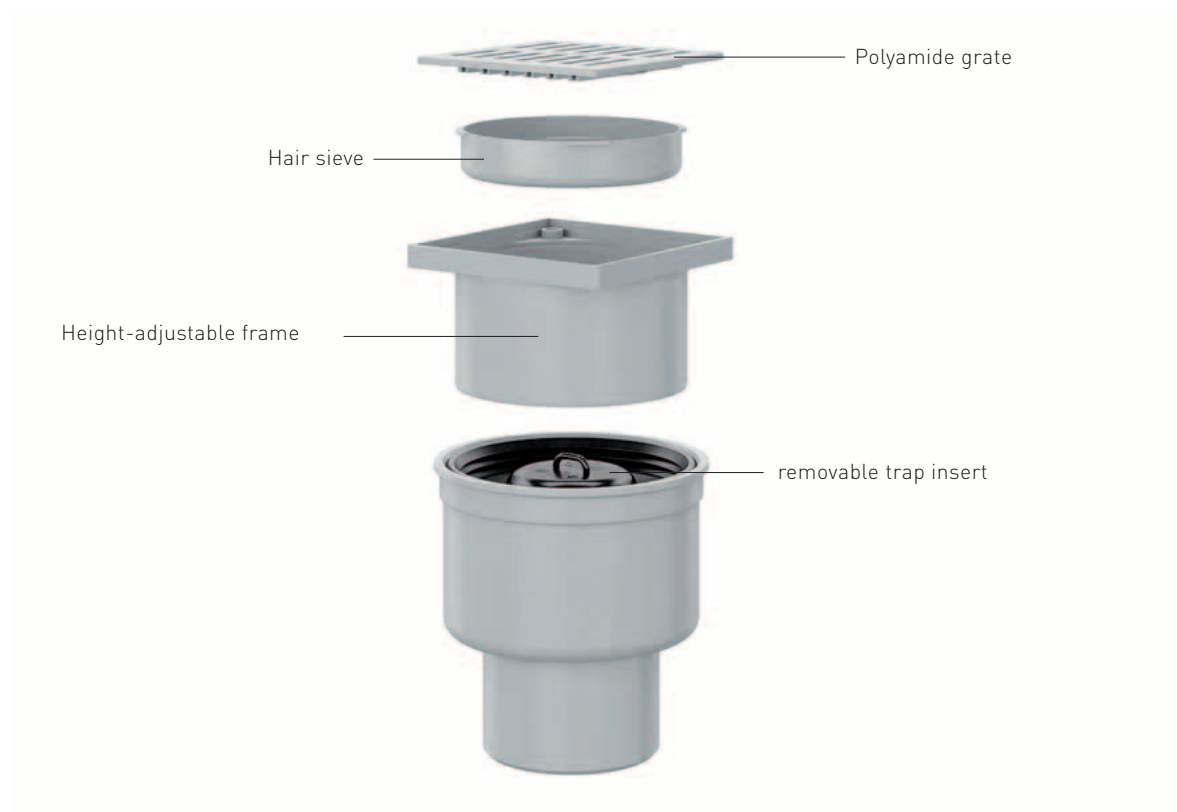

# Utility drains without anti-flooding device

## DALLMER utility drain type 57 AK

conforming to DIN EN 1253  
outlet horizontal (3 degrees fall)

### SPECIFICATION

- trap and rodding eye, 60 mm water seal
- height adjustable grating
- hair sieve

### MATERIAL

body polypropylene,  
frame polypropylene, 150 x 150 mm, grate polyamide, load class K 3 (300 kg),  
stainless steel grate available on request.

- **utility drain type 57 AK Primus**  
with removable Primus trap insert, using a floating bell, which sinks to seal the trap if water evaporates (hair sieve not fitted)

### The Primus system:



With water, it's a bell-trap

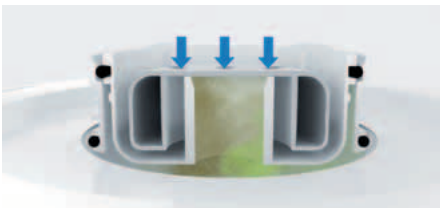

Without water the bell sinks to seal the pipe

### FLOW RATE TESTED TO DIN EN 1253 (with 20 mm water over grate)

	Required	Dallmer
DN 70	0.8 l/s	1.47 l/s
DN 100	1.4 l/s	1.67 l/s
DN 100 Primus	1.4 l/s	1.61 l/s

ITEM	DN	PART NO.
utility drain type 57 AK	DN 70	570840
utility drain type 57 AK	DN 100	570864
utility drain type 57 AK Primus	DN 100	570901



utility drain type 57 AK

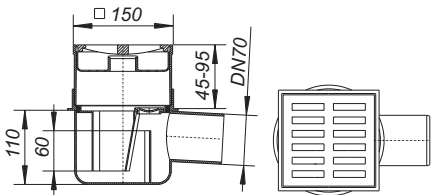

Recess size: 240 x 370 mm

No flange for water-proofing membranes.



# Utility drains without anti-flooding device

## DALLMER utility drain type 61 AK

conforming to DIN EN 1253  
outlet DN 100 vertical

### SPECIFICATION

- removable trap insert, 50 mm water seal
- height adjustable grating
- hair sieve

### MATERIAL

body polypropylene,  
frame polypropylene, 150 x 150 mm, grate polyamide, load class K 3 (300 kg),  
stainless steel grate available on request.

- utility drain type 61 AK Primus  
with removable Primus trap insert, using a floating bell, which sinks to seal the trap if water evaporates (hair sieve not fitted)

### The Primus system:



With water, it's a bell-trap

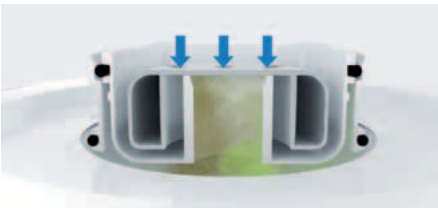

Without water the bell sinks to seal the pipe

### FLOW RATE TESTED TO DIN EN 1253 (with 20 mm water over grate)

	Required	Dallmer
DN 100	1.4 l/s	1.70 l/s
DN 100 Primus	1.4 l/s	1.79 l/s

ITEM	DN	PART NO.
utility drain type 61 AK	DN 100	610867
utility drain type 61 AK Primus	DN 100	610805



utility drain type 61 AK

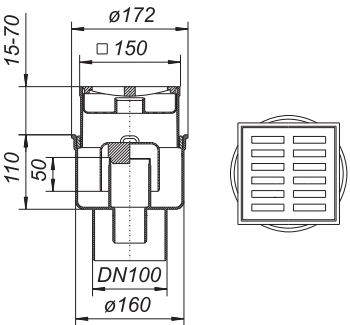

## DALLMER floor drain type 60

outlet DN 50 vertical  
with bell trap, 25 mm water seal

### MATERIAL

polypropylene  
frame polypropylene, 100 x 100 mm, grate polyamide, incorporating bell trap

### FLOW RATE TESTED TO DIN EN 1253 TAB. 3, (with 20 mm water over cover plate), conforming to DIN EN 274

	Required	Dallmer
DN 50	0.4 l/s	0.6 l/s

ITEM	DN	DIMENSION	PART NO.
floor drain type 60	DN 50	100 x 100 mm	600509



floor drain type 60

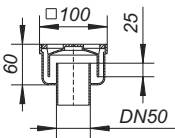

No flange for water-proofing membranes.

# Utility drains without anti-flooding device

## DALLMER utility drain type 71

conforming to DIN EN 1253  
outlet DN 100 horizontal (3 degrees fall)

### SPECIFICATION

- removable trap insert, 50 mm water seal
- bucket

### MATERIAL

polypropylene  
frame polypropylene, 170 x 240 mm, grate ABS, load class K 3 (300 kg)

- utility drain type 71/1  
with DN 50 side inlet
- utility drain type 71/3  
with DN 70 side inlet and DN 70 bosses in 2 alternative positions

### FLOW RATE TESTED TO DIN EN 1253 (with 20 mm water over grate)

	Required	Dallmer
DN 100	1.4 l/s	2.7 l/s
DN 100 Zulauf DN 50	1.4 l/s	2.2 l/s
DN 100 Zulauf DN 70	1.4 l/s	2.2 l/s

ITEM	DN	PART NO.
utility drain type 71	DN 100	710062
utility drain type 71/1, DN 50 side inlet	DN 100	710161
utility drain type 71/3, DN 70 side inlet	DN 100	710369



utility drain type 71

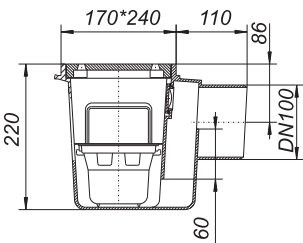

utility drain type 71/1

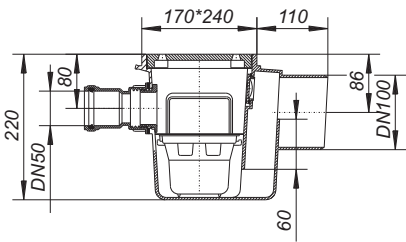

utility drain type 71/3

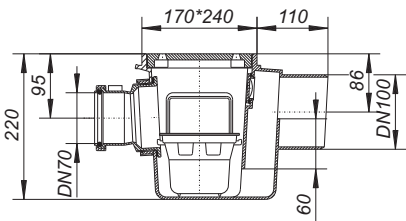

# Utility drains without anti-flooding device

## DALLMER extension for utility drain 71

used with type 71 utility drain  
can be cut to correct height on site

### MATERIAL

ABS, grey

ITEM	DIMENSION	PART NO.
extension for utility drain	100 mm	714954



extension for utility drain

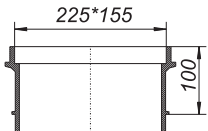

## DALLMER grate for utility drain 71

used with type 71 utility drain

- ▶ **grate for utility drain 71, grey**  
ABS, grey, 225 x 155 mm, load class K 3 (300 kg)
- ▶ **grate for utility drain 71, white**  
ABS, white, 225 x 155 mm, load class K 3 (300 kg)
- ▶ **grate for utility drain 71, cast iron**  
cast iron, 225 x 155 mm, load class L 15 (1.5 t)

ITEM	DIMENSION	PART NO.
grate for utility drain 71, grey	225 x 155 mm	714923
grate for utility drain 71, white	225 x 155 mm	714930
grate for utility drain 71, cast iron	225 x 155 mm	714947



grate for utility drain 71, grey

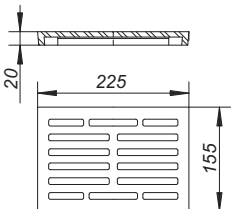

# Utility drains without anti-flooding device

## DALLMER floor drain PRONTO

pushes into a pipe, for floor constructions without a waterproofing membrane

### SPECIFICATION

- trap insert removable for cleaning, 50 mm water seal
- flexible sealing ribs

### MATERIAL

polypropylene/rubber/TPE

frame 304 stainless steel, 120 x 120 mm

grate 304 stainless steel, 115 x 115 mm, load class K 3 (300 kg)

FLOW RATE TESTED TO DIN EN 1253 TAB. 3,  
(with 20 mm water over cover plate), conforming to DIN EN 274

	Required	Dallmer
DN 100	0.4 l/s	0.8 l/s
DN 125	0.4 l/s	0.8 l/s

ITEM	DN	DIMENSION	PART NO.
floor drain PRONTO	DN 100	120 x 120 mm	700063
floor drain PRONTO	DN 125	120 x 120 mm	700087

The trap assembly can be easily removed and the fitting used for rodding access.



floor drain PRONTO

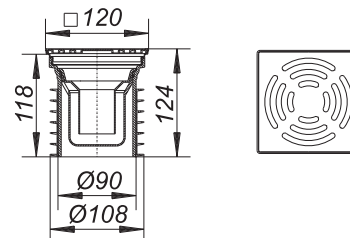

## DALLMER floor drain PRONTO K

pushes into a pipe, for floor constructions without a waterproofing membrane

### SPECIFICATION

- trap insert removable for cleaning, 50 mm water seal
- flexible sealing ribs

### MATERIAL

polypropylene/rubber/TPE

frame polypropylene, 120 x 120 mm

- ▶ floor drain PRONTO K  
grate 304 stainless steel, 115 x 115 mm, load class K 3 (300 kg)
- ▶ floor drain PRONTO K, secured  
grate 304 stainless steel, 115 x 115 mm, secured, load class K 3 (300 kg)
- ▶ floor drain PRONTO K  
grate 304 stainless steel, 115 x 115 mm, load class K 3 (300 kg)
- ▶ floor drain PRONTO K Alu  
grate aluminium

FLOW RATE TESTED TO DIN EN 1253 TAB. 3,  
(with 20 mm water over cover plate), conforming to DIN EN 274

	Required	Dallmer
DN 100	0.4 l/s	0.82 l/s
DN 125	0.4 l/s	0.82 l/s

ITEM	DN	DIMENSION	PART NO.
floor drain PRONTO K	DN 100	120 x 120 mm	700360
floor drain PRONTO K, secured	DN 100	120 x 120 mm	700391
floor drain PRONTO K	DN 125	120 x 120 mm	700384
floor drain PRONTO K Alu	DN 100	120 x 120 mm	700339
floor drain PRONTO K Alu	DN 125	120 x 120 mm	700346



floor drain PRONTO K, DN 100

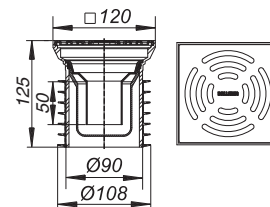

floor drain PRONTO K Alu, DN 100

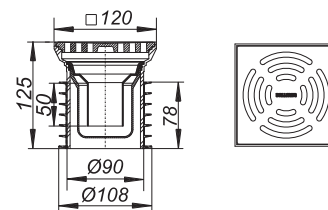

# Utility drains without anti-flooding device

## DALLMER floor drain PRONTO Primus

pushes into a DN 100 pipe

### SPECIFICATION

- removable Primus trap insert, using a floating bell, which sinks to seal the trap if water evaporates
- flexible sealing ribs

### MATERIAL

polypropylene/rubber/TPE

frame 304 stainless steel, 120 x 120 mm

grate 304 stainless steel, 115 x 115 mm, load class K 3 (300 kg)

### The Primus system:



With water, it's a bell-trap

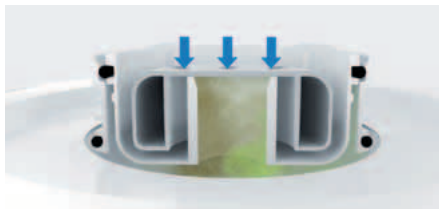

Without water the bell sinks to seal the pipe

FLOW RATE TESTED TO DIN EN 1253 TAB. 3,  
(with 20 mm water over cover plate), conforming to DIN EN 274

	Required	Dallmer
DN 100	0.4 l/s	0.4 l/s

ITEM	DN	DIMENSION	PART NO.
floor drain PRONTOPrimus	DN 100	120 x 120 mm	700032



floor drain PRONTOPrimus

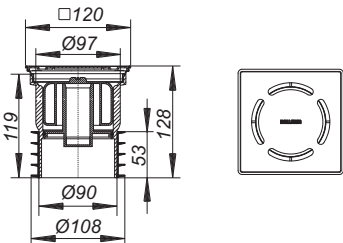

## DALLMER self-closing flap-valve S 10/12

for use with floor drain PRONTO in place of trap insert (except for PRONTO K Alu), gratings and frames series 10 with 120 x 120 mm or with d: 120 mm, and for frames type SES 10/ECS 12.

Used on combined foul and rainwater systems, the flap-valve allows water to drain whilst preventing the escape of foul air and foam.

With no water seal, it cannot freeze!

### SPECIFICATION

- self-closing flap

### MATERIAL

ABS

ITEM	DIMENSION	PART NO.
self-closing flap-valve S 10/12	d: 108,5 mm	495846



self-closing flap-valve S 10/12

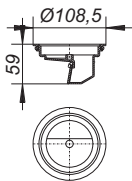

# Klenkmatik drains

## DALLMER Klenkmatik drain type K 1

with automatic flap/seal  
outlet DN 100 vertical

### MATERIAL

body polyamide,  
grate polyamide, secured, load class L 15 (1.5 t)

ARTIKEL	NENNWEITE	ART. NR
Klenkmatik drain type K 1	DN 100	730169



Klenkmatik drain type K 1

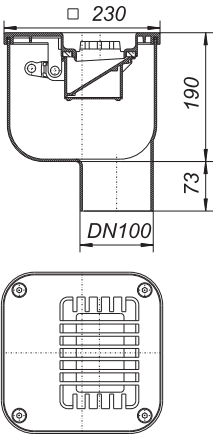

## DALLMER Klenkmatik drain type K 2

with automatic flap/seal  
outlet DN 100 horizontal (3 degrees)

### MATERIAL

body polyamide,  
grate polyamide, secured, load class L 15 (1.5 t)

ARTIKEL	NENNWEITE	ART. NR
Klenkmatik drain type K 2	DN 100	730060



Klenkmatik drain type K 2

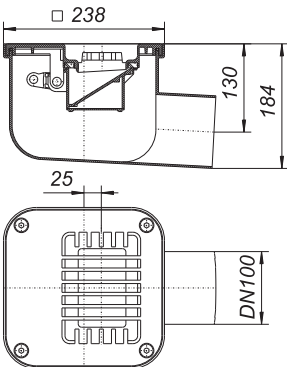

The sealing plate is counterbalanced. When it fills with water, it automatically empties and re-seals. Ideal on combined sewer/surface water drains eg. at the base of rainwater pipes.



# What else we can do for you?

*Everything that supports you with your work  
– from warranty to technology*



A promise that you can pass on to  
your customers

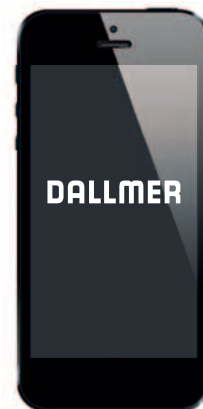

The new Dallmer App  
for Professionals

Our new Dallmer App is ideal for anyone dealing with building drainage engineering. It not only offers architects, planners, installers, building owners and property owners detailed product information, but also a series of useful additional functions. This includes:

- Installation instructions
- Installation videos
- Catalogues / brochures
- Pictures
- Search tool with bar code scanner
- Messages and product innovations

Always here for you:  
The DALLMER Service hotline

0800 DALLMER (3255637)

Monday – Thursday: 7:15 to 17:00  
Friday: 7:15 to 14:00  
or our UK technical service  
+44 (0) 1787 248244  
Monday – Friday: 9:00 to 17:00

\* Subject to warranty conditions as of January 2013: <http://www.dallmer.de/en/agb>

Dallmer GmbH + Co. KG  
Wiebelsheidestr. 25  
59757 Arnsberg  
Germany

P +49 2932 9616 - 0  
F +49 2932 9616 - 222  
E [info@dallmer.de](mailto:info@dallmer.de)  
W [www.dallmer.de](http://www.dallmer.de)  
[www.cerawall.de](http://www.cerawall.de)

Dallmer Ltd.  
4 Norman Way  
Lavenham, Sudbury  
Suffolk CO10 9PY  
Great Britain

P +44 (0) 1787 248 244  
F +44 (0) 1787 248 246  
E [info@dallmer.com](mailto:info@dallmer.com)  
W [www.dallmer.com](http://www.dallmer.com)  
[www.cerawall.com](http://www.cerawall.com)